

Official copy of register of title

Title number CB439176

Edition date 09.01.2019

- This official copy shows the entries in the register of title on 23 January 2020 at 15:34:49.
- This date must be quoted as the "search from date" in any official search application based on this copy.
- The date at the beginning of an entry is the date on which the entry was made in the register.
- Issued on 23 January 2020.
- Under s.67 of the Land Registration Act 2002, this copy is admissible in evidence to the same extent as the original.
- For information about the register of title, see www.gov.uk/land-registry.
- This title is dealt with by HM Land Registry Peterborough Office.

A: Property register

This register describes the land and estate comprised in the title.

CAMBRIDGESHIRE : SOUTH CAMBRIDGESHIRE

- 1 (09.01.2019) The Freehold land shown edged with red on the plan of the above title filed at the Registry and being land lying to the east of Ouse Fen Road, Over, Cambridge.
- 2 (09.01.2019) The land has the benefit of any legal easements granted by a Conveyance of the land in this title dated 7 March 1984 made between (1) F W Deptford (Over) Limited and (2) Over Parish Council but is subject to any rights that are reserved by the said deed and affect the registered land.

NOTE: Copy filed.

B: Proprietorship register

This register specifies the class of title and identifies the owner. It contains any entries that affect the right of disposal.

Title absolute

- 1 (09.01.2019) PROPRIETOR: OVER PARISH COUNCIL care of Over Conference & Community Centre, The Doles, Over, Cambridge CB24 5NW.

End of register

HM Land Registry
Official copy of
title plan

Title number **CB439176**
Ordnance Survey map reference **TL3871NW**
Scale **1:2500**
Administrative area **Cambridgeshire: South
Cambridgeshire**

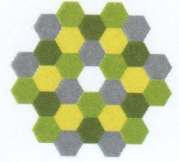

© Crown copyright and database rights 2019 Ordnance Survey 100026316.
You are not permitted to copy, sub-license, distribute or sell any of this data to third parties in any form.

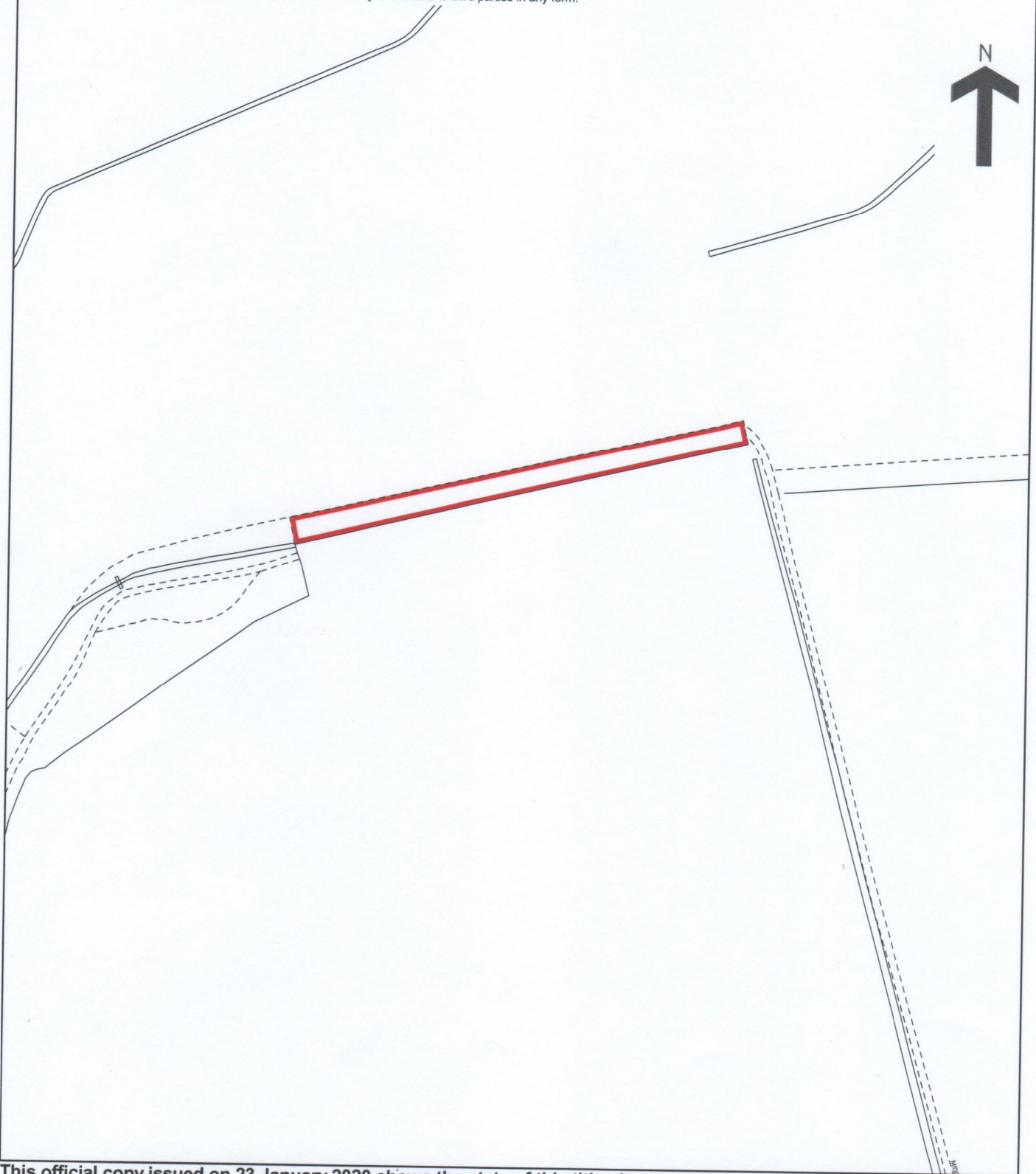

This official copy issued on 23 January 2020 shows the state of this title plan on 23 January 2020 at 15:34:49.

It is admissible in evidence to the same extent as the original (s.67 Land Registration Act 2002).

This title plan shows the general position, not the exact line, of the boundaries. It may be subject to distortions in scale.

Measurements scaled from this plan may not match measurements between the same points on the ground.

This title is dealt with by HM Land Registry, Peterborough Office.