

Official copy of register of title

Title number CB419974

Edition date 12.01.2017

- This official copy shows the entries in the register of title on 19 April 2017 at 15:48:07.
- This date must be quoted as the "search from date" in any official search application based on this copy.
- The date at the beginning of an entry is the date on which the entry was made in the register.
- Issued on 19 April 2017.
- Under s.67 of the Land Registration Act 2002, this copy is admissible in evidence to the same extent as the original.
- For information about the register of title see Land Registry website www.landregistry.gov.uk or Land Registry Public Guide 1 - *A guide to the information we keep and how you can obtain it*.
- This title is dealt with by Land Registry Peterborough Office.

A: Property register

This register describes the land and estate comprised in the title.

CAMBRIDGESHIRE : SOUTH CAMBRIDGESHIRE

- 1 (12.01.2017) The Freehold land shown edged with red on the plan of the above title filed at the Registry and being Land at Sandpit Pond, Longstanton Road, Over, Cambridge.

B: Proprietorship register

This register specifies the class of title and identifies the owner. It contains any entries that affect the right of disposal.

Title absolute

- 1 (12.01.2017) PROPRIETOR: OVER PARISH COUNCIL of 32 West Street, Over, Cambridge CB24 5PL.
- 2 (12.01.2017) The value as at 12 January 2017 was stated to be under £80,000.

End of register

HM Land Registry
Official copy of
title plan

Title number **CB419974**
Ordnance Survey map reference **TL3769NE**
Scale **1:1250** enlarged from 1:2500
Administrative area **Cambridgeshire: South
Cambridgeshire**

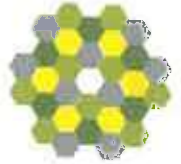

© Crown copyright and database rights 2017 Ordnance Survey 100026316.
You are not permitted to copy, sub-license, distribute or sell any of this data to third parties in any form.

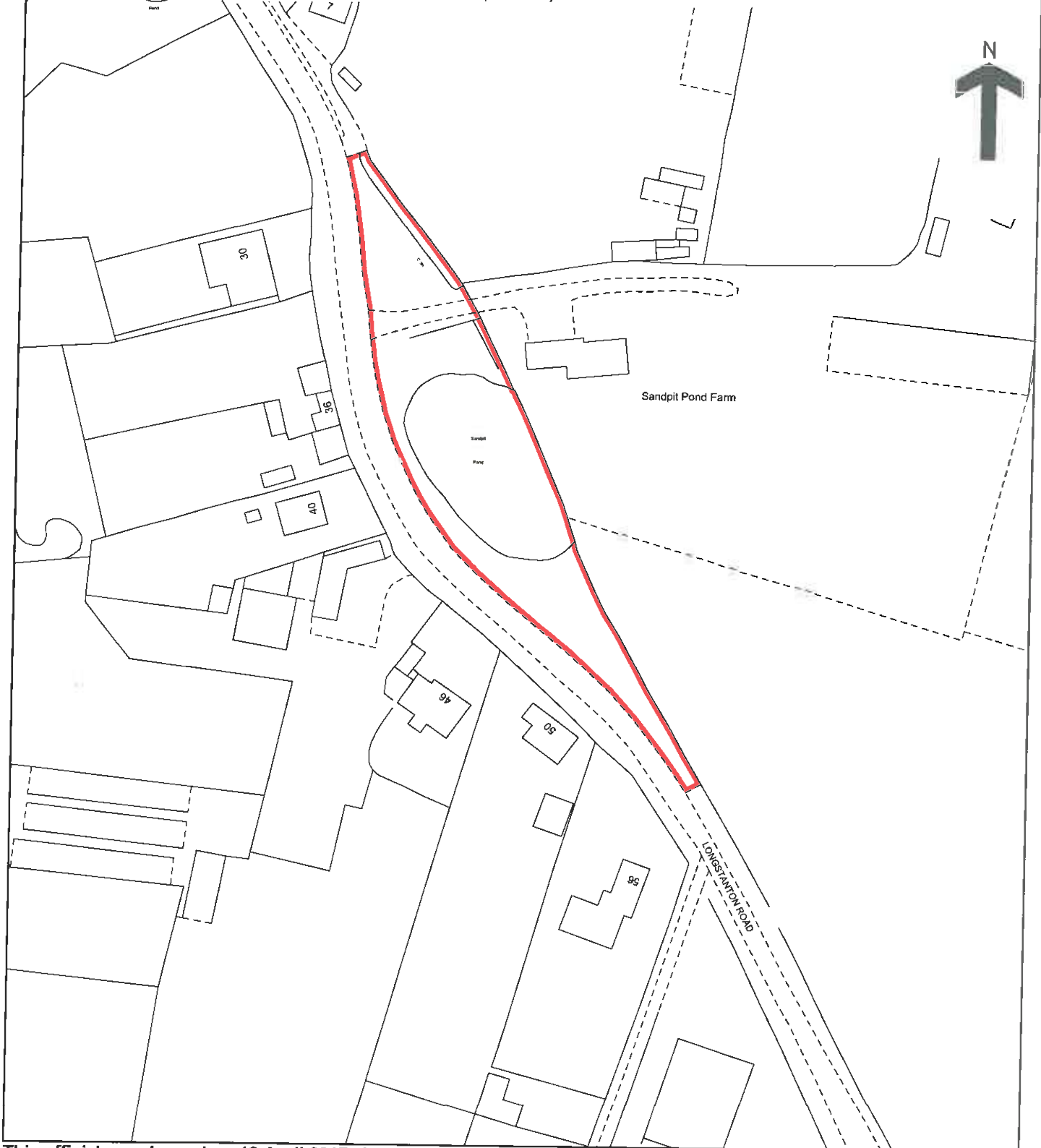

This official copy issued on 19 April 2017 shows the state of this title plan on 19 April 2017 at 15:48:07. It is admissible in evidence to the same extent as the original (s.67 Land Registration Act 2002).
This title plan shows the general position, not the exact line, of the boundaries. It may be subject to distortions in scale. Measurements scaled from this plan may not match measurements between the same points on the ground.
This title is dealt with by HM Land Registry, Peterborough Office.